



Stuart Patterson

Building & Timber Frame Design

5 Burnflat Lane, Hawick, Roxburghshire, TD9 0DZ

phone/fax - 01450 375772

email - stuartpattersondesign@gmail.com

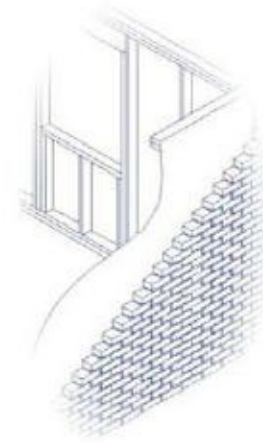

Proposed Extension & Alteration at Whinfield Cottage, Chesters, Hawick, TD9 8TQ
For Mr E. Alanizi

Photographs of Surrounding Properties



Broomhills



Mirador



October House
(Looking West)



October House



Souden View & River View



Souden View
(Roof of Whinfield Cottage visible to left)



Whinfield Cottage & Souden View



Dean Cottage



Avenslea



Chesters Cottage



Rowanbank